

Series KQ2

Double Branch Universal Male Elbow: KQ2ZD

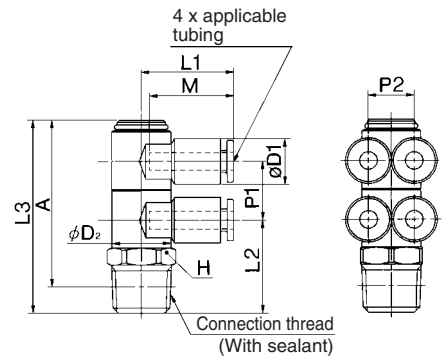

Applicable tubing O.D. (mm)	Connection threads R	Model	H (width across flats)	Note) $\phi D1$	$\phi D2$	L1	L2	L3	A*	M	P1	P2	Mass (g)
4	1/8	KQ2ZD04-01S	14	10.4	13.4	21	17.6	40.1	37	16	13.4	10.4	25
	1/4	KQ2ZD04-02S					21	43.5	38				31
	3/8	KQ2ZD04-03S					17	22.4	44.9				40
6	1/8	KQ2ZD06-01S	14	12.8	13.4	22	17.6	40.1	37	17	13.4	12.8	27
	1/4	KQ2ZD06-02S					21	43.5	38				33
	3/8	KQ2ZD06-03S					17	22.4	44.9				40
8	1/8	KQ2ZD08-01S	19	15.2	17.6	26	20.1	47.1	44	18.5	15.9	15.2	56
	1/4	KQ2ZD08-02S					23.5	50.5	45				54
	3/8	KQ2ZD08-03S					23.5	50.9	45.5				62
	1/2	KQ2ZD08-04S					21	27.6	54.6				47.5
10	1/4	KQ2ZD10-02S	21	18.5	20.6	29	26	57.5	52	21	19.2	18.5	83
	3/8	KQ2ZD10-03S					26.4	57.9	53				85
	1/2	KQ2ZD10-04S					29.6	61.1	54				102
12	1/4	KQ2ZD12-02S	26	20.9	25.2	32	28	64	58.5	22	21.6	20.9	134
	3/8	KQ2ZD12-03S					28.5	64.4	59				130
	1/2	KQ2ZD12-04S					31.6	67.6	60				141



* Reference dimensions after R thread installation.
Note) $\phi D1$: Max. diameter



Triple Branch Universal Male Elbow: KQ2ZT



Applicable tubing O.D. (mm)	Connection threads R	Model	H (width across flats)	Note) $\phi D1$	$\phi D2$	L1	L2	L3	A*	M	P1	P2	Mass (g)
4	1/8	KQ2ZT04-01S	14	10.4	13.4	21	16.7	53.6	50.5	16	13.4	10.4	34
	1/4	KQ2ZT04-02S					20.5	57	51.5				40
	3/8	KQ2ZT04-03S					17	22.4	58.4				53.5
6	1/8	KQ2ZT06-01S	14	12.8	13.4	22	17.6	53.6	50.5	17	13.4	12.8	38
	1/4	KQ2ZT06-02S					21	57	51.5				43
	3/8	KQ2ZT06-03S					17	22.4	58.4				53.5
8	1/8	KQ2ZT08-01S	19	15.2	17.6	26	20.1	63.1	60	18.5	15.9	15.2	76
	1/4	KQ2ZT08-02S					23.5	66.5	61				72
	3/8	KQ2ZT08-03S					23.5	66.9	61.5				81
	1/2	KQ2ZT08-04S					21	27.6	70.6				63.5
10	1/4	KQ2ZT10-02S	21	18.5	20.6	29	26	77	71.5	21	19.2	18.5	111
	3/8	KQ2ZT10-03S					26.4	77.4	72				128
	1/2	KQ2ZT10-04S					29.6	80.6	73.5				128
12	1/4	KQ2ZT12-02S	26	20.9	25.2	32	28	85.5	80	22	21.6	20.9	178
	3/8	KQ2ZT12-03S					28.5	85.9	80.5				167
	1/2	KQ2ZT12-04S					31.6	89.1	82				179

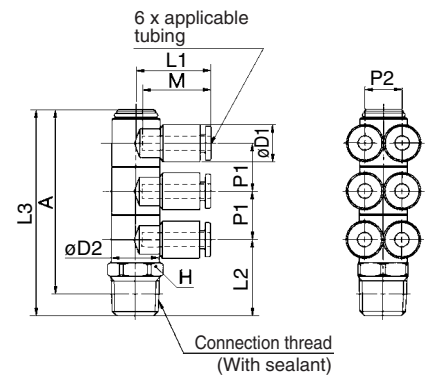

* Reference dimensions after R thread installation.
Note) $\phi D1$: Max. diameter



Union Elbow: KQ2L



Applicable tubing O.D. (mm)	Model	$\phi D^{(1)}$	L	Q	M	Effective area ⁽²⁾ (mm ²)		Mass (g)
						Nylon	Urethane	
3.2	KQ2L23-00	9.6	17.5	4.3	15.5	3	2.5	3
4	KQ2L04-00	10.4	18	4.5	16	4.2	4.2	6
6	KQ2L06-00	12.8	20	5.3	17	11.4	9.0	6
8	KQ2L08-00	15.2	23	6	18.5	21.6	14.9	10
10	KQ2L10-00	18.5	26.5	6.8	21	35.2	25.0	17
12	KQ2L12-00	20.9	28.5	7.5	22	50.2	39.7	21
16	KQ2L16-00	26.5	34	10	25	100	(84)	29

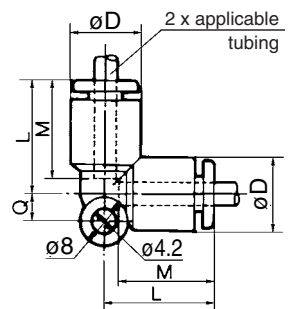

Note 1) ϕD : Max. diameter
Note 2) (): Valves for soft nylon.