

END CAPS

All end caps are non-aging and oil-resistant ABS, grey, thickness 3 mm. The end caps are also available in black on demand. For cut-off face covering of profiles. No deburring necessary.

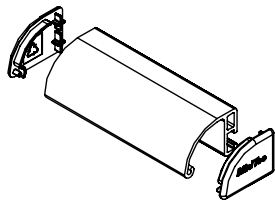

End cap handle profile

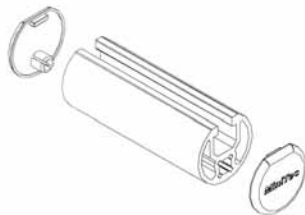

End cap handle profile 32

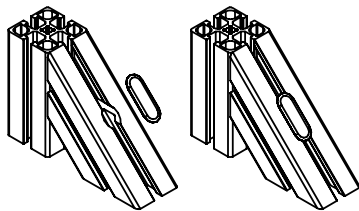

End cap GL

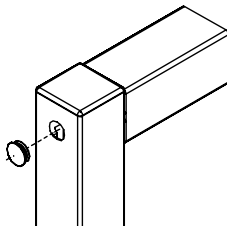

Lamellar plug

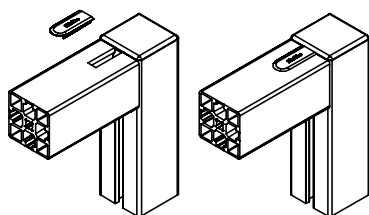

End cap G

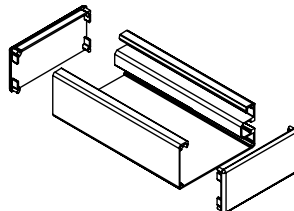

90 Al cable channel

For profile:	Part no. Profile	Part no. End cap
19 x 32	20.1000/0	22.1060/1
19 x 45	20.1001/0	22.1064/1
45 x 19	20.1012/0	22.1063/1
32 x 32 UL, F	-	22.1062/1
Clamp profile 32 x 32	20.1068/0	22.1032/1
		22.1032/3, with drilling
Handle profile 32	20.1088/0	22.1023/1
45 x 32 UL, F	-	22.1065/1
Clamp profile 45 x 32	20.1053/0	22.1046/1
		22.1046/3, with drilling
45 x 45, UL, F, G, 2G, 3G	-	22.1067/1
45 x 45 R	20.1046/0	22.1065/1
45 R 90°	20.1069/0	22.1034/1
45/45°	20.1029/0	22.1051/1
45/22,5°	20.1030/0	22.1052/1
90 x 19	20.1031/0	22.1053/1
90 x 32 UL	20.1066/0	22.1061/1
45 x 90, UL, F, S, G	-	22.1068/1
45 x 60 F	20.1023/0	22.1058/1
60 x 60 F	20.1049/0	22.1057/1
45 x 135 G	20.1024/0	22.1049/1
45 x 180 G	20.1026/0	22.1048/1
90 x 90 L, S, 2G	-	22.1069/1
32 x 180	20.1016/0	22.1059/1
90 x 180 S	20.1013/0	2 x 22.1069/1
Handle profile right	20.1045/0	22.1054/0
Handle profile left	20.1045/0	22.1055/0
Conduit 90 Al	20.1056/0	22.1045/0
90 R 90°	20.1091/0	22.1021/1

Designation		Part no. End cap
End cap G	(PA 6)	22.1056/1
End cap GL	(PA 6)	22.1208/1
Lamellar plug 7	(PE)	22.1200/1
Lamellar plug 9	(PE)	22.1201/1
Lamellar plug 15	(PE)	22.1202/1

End cap Aluminium

Designation	Part no. End cap
End cap 45 x 45 Al	22.1067/2
End cap 45 x 90 Al	22.1068/2
End cap 19 x 45 Al	22.1064/2

(End cap AL, anodized, thickness: 2,5 mm, without screw; suitable screw: countersunk screw M8 x 20)

End cap stainless steel

Designation	Part no. End cap
End cap 45 x 45 AV	22.1067/5

(End cap VA, stainless steel, thickness: 5 mm, without screw; suitable screw: countersunk screw VA M8 x 16)