

## DWG6 SERIES SOLENOID OPERATED DIRECTIONAL CONTROL VALVES



DWG6 series directional control valves are solenoid operated directional spool valves, these valves are used to the start, stop and direct flow.

### ▶ Technical data

|   |                             |
|---|-----------------------------|
| Size                                    | 6                           |
| Max. flow rate (L/min)                  | 60                          |
| Operating pressure (MPa)                | A, B, P oil port 31.5       |
|   | T oil port 16               |
| Without Handle/With Handle              | 1.6/2.2                     |
| Weight (KGS)                            | 2.2/2.8                     |
| Valve body (Material) Surface treatment | casting phosphating surface |

### ▶ Characteristic curves (measured with HLP46, $V_{oil}=40^{\circ}\text{C} \pm 5^{\circ}\text{C}$ [104°F ± 9°F])

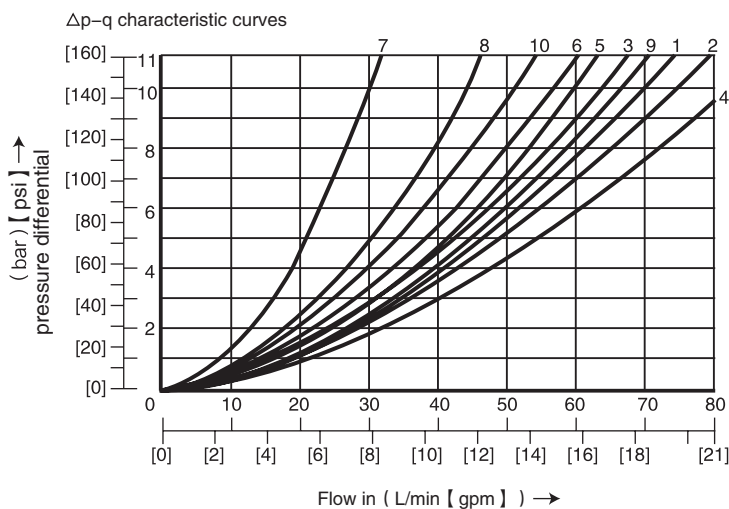

7 Spool symbol "R" in spool position B→A  
 8 Spool symbol "G" and "T" in central position  
 9 Spool symbol "H" and "T" in central position P→T

| Spool symbol | Flow direction |     |     |     |
|--------------|----------------|-----|-----|-----|
|              | P-A            | P-B | A-T | B-T |
| A; B         | 3              | 3   | -   | -   |
| C            | 1              | 1   | 3   | 1   |
| D; Y         | 5              | 5   | 3   | 3   |
| E            | 3              | 3   | 1   | 1   |
| F            | 1              | 3   | 1   | 1   |
| T            | 10             | 10  | 9   | 9   |
| H            | 2              | 4   | 2   | 2   |
| J; Q         | 1              | 1   | 2   | 1   |
| L            | 3              | 3   | 4   | 9   |
| M            | 2              | 4   | 3   | 3   |
| P            | 3              | 1   | 1   | 1   |
| R            | 5              | 5   | 4   | -   |
| V            | 1              | 2   | 1   | 1   |
| W            | 1              | 1   | 2   | 2   |
| U            | 3              | 3   | 9   | 4   |
| G            | 6              | 6   | 9   | 9   |

► Spool symbols

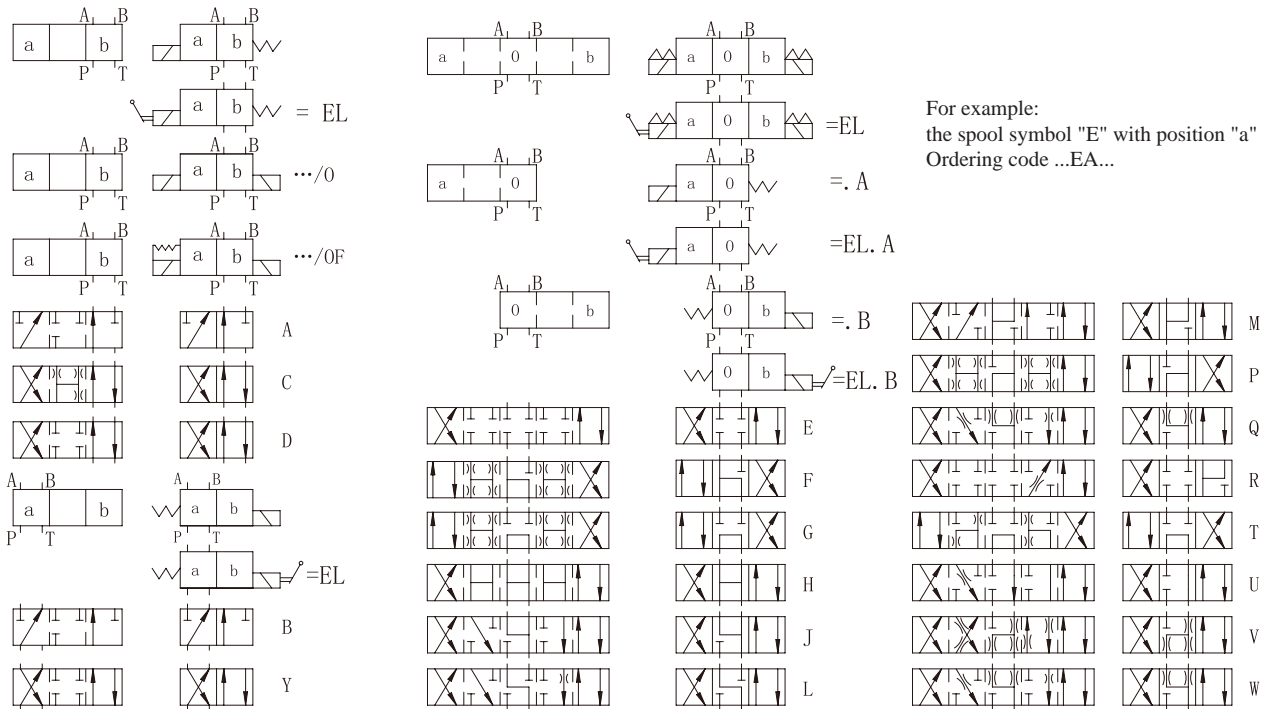

► DWG6 Subplate Installation Dimensions

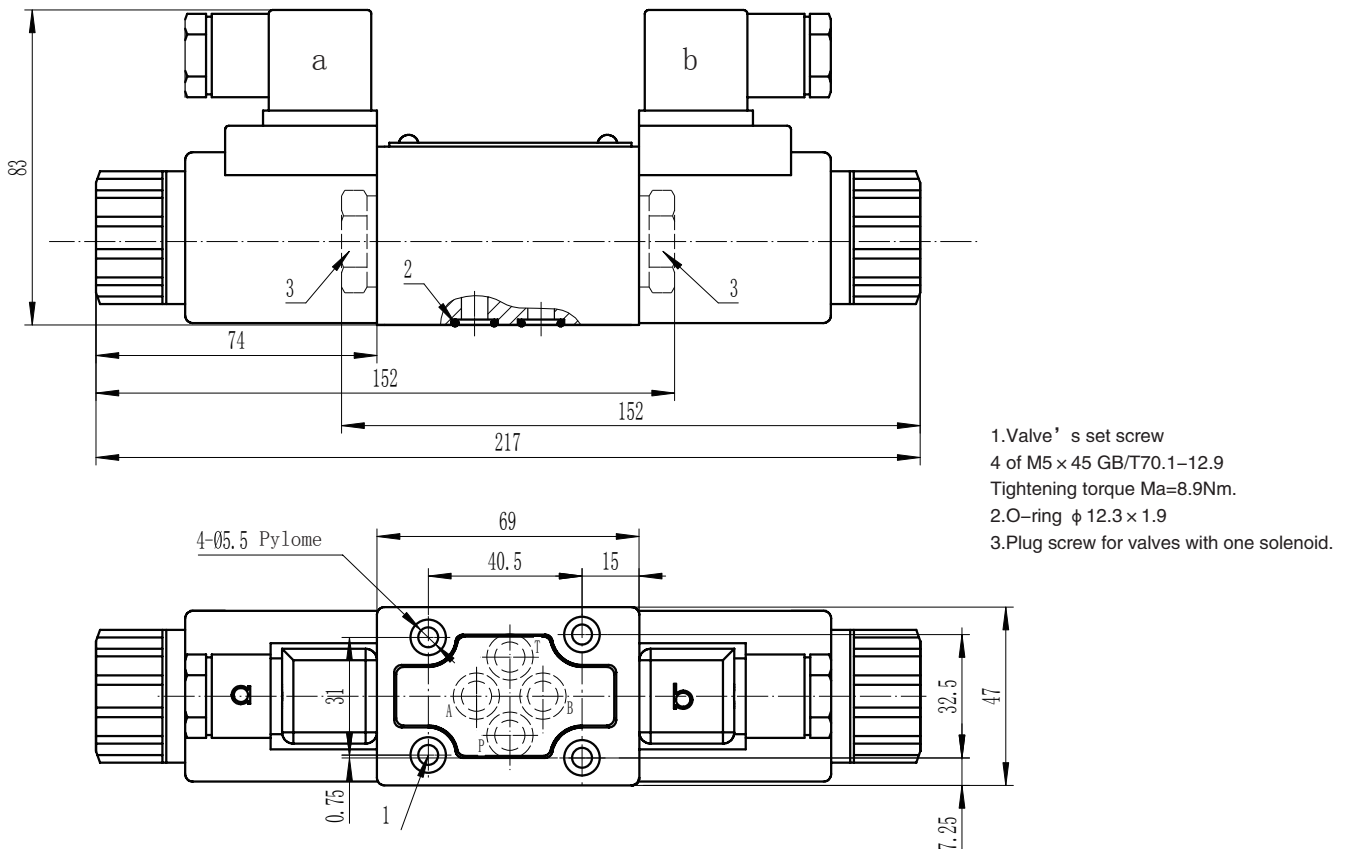

## DWG6-EL Subplate Installation Dimensions

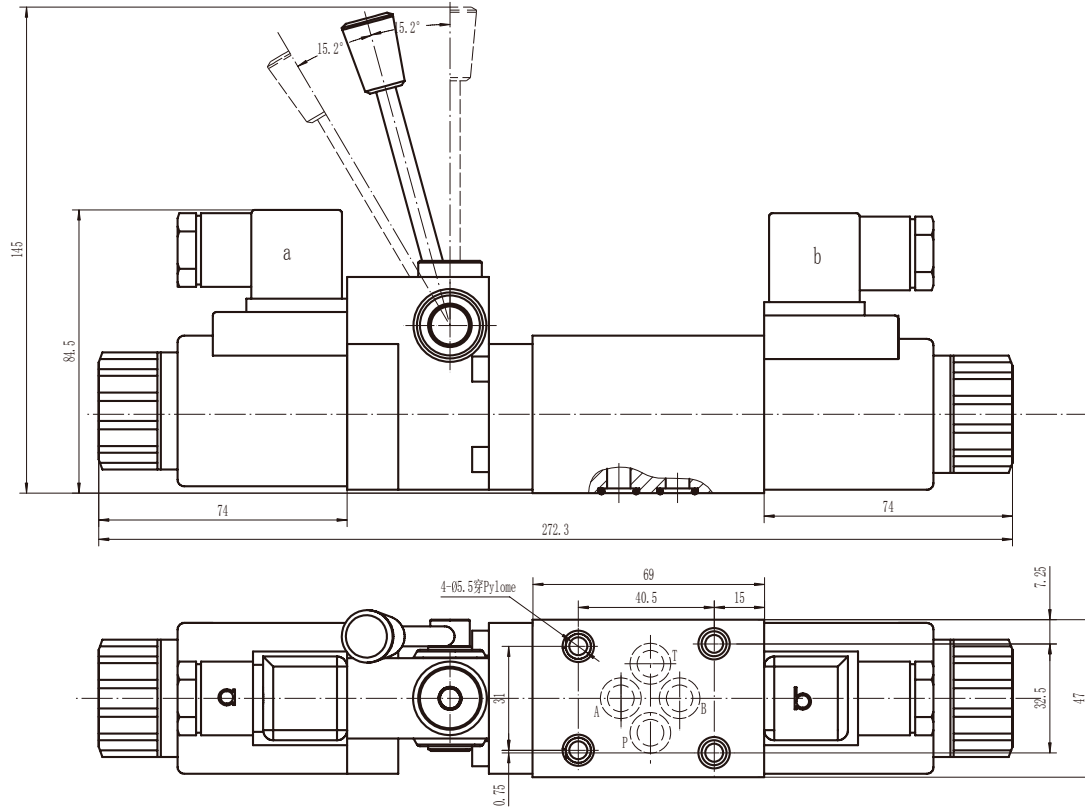

## DWG6 Subplate Installation Dimensions

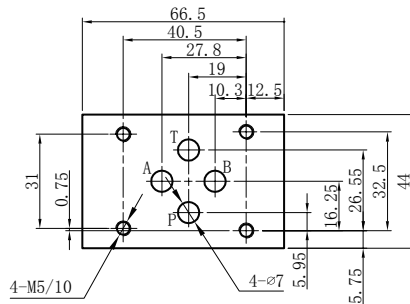

Installations are the same with  
Z1DS6,Z2DS6,Z2FDS6,ZPB6,ZPR6

|   |     |   |   |   |    |   |      |   |     |   |   |   |
|---|-----|---|---|---|----|---|------|---|-----|---|---|---|
| 4 | DWG | 6 | * | E | 60 | * | DC24 | N | Z5L | * | * | * |
|---|-----|---|---|---|----|---|------|---|-----|---|---|---|

3=3-way  
4=4-way  
Size 6

1.No code=Without hand lever  
2.EL=With hand lever  
Spool Type

Series 60=60 Solenoid coils with thread connection

No code=With spring return;O=Without spring return  
OF=Without spring return with detent

Voltage  
DC12;DC24 ;AC110;AC220

For further details

No code=NBR seals  
V=FPM seals

No code=Without orifice insert  
B08=Orifice size0.8mm  
B10=Orifice size1.0mm  
B12=Orifice size1.2mm

Z5L=Large quadrate plug with light  
ZC=Waterproof connector  
JS=Wire box connector

N =With concealed manual override  
No Code =Without concealed manual override